

## Unitorch EL-120 Retrofit

Model: EL120M

A Single RPT Torch For Any Plasma Systems From 30 to 120A • EN60974-7

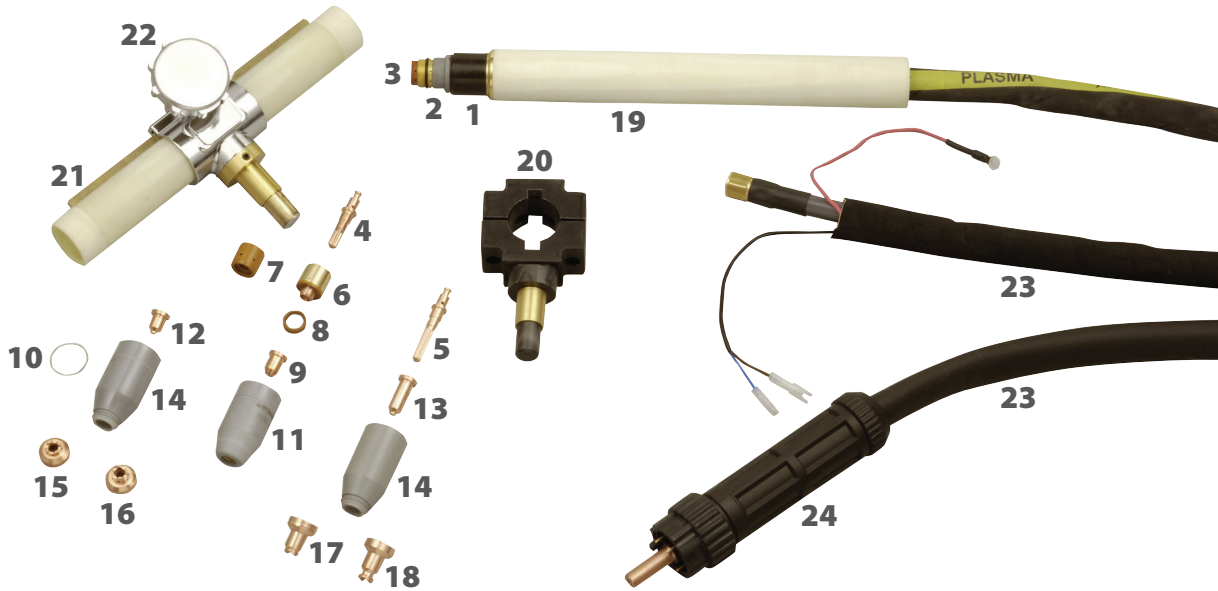

### Torch Packages

Code	Description
09020	Non HF c/w 6m Cables 9/16" Fitting
09021	Non HF c/w 6m Cables Central Fitting
09030	Non HF c/w 12m Cables 9/16" Fitting
09031	Non HF c/w 12m Cables Central Fitting
09020HF	With HF c/w 6m Cables 9/16" Fitting
09021HF	With HF c/w 6m Cables Central Fitting
09030HF	With HF c/w 12m Cables 9/16" Fitting
09031HF	With HF c/w 12m Cables Central Fitting

### Main Consumables

Code	Description	Pack Qty
1 07921	Torch Head	1
2 07300.60	'O' Ring - Torch Head Outer	10
3 07920.60	'O' Ring - Torch Head Inner	10
4 52600	Electrode Air / N2	5
5 52603	Extended Electrode Air / N2	5
6 07923	Start Cartridge - Non HF	1
7 07924	Insulator - HF	1
8 60060	Gas Distributor 30/60A	2
8 60061	Gas Distributor 60/120A	2
9 51470	Cutting Tip 30A	10
9 51471	Cutting Tip 40A	10
9 51472	Cutting Tip 50/60A	10
9 51474	Cutting Tip 60A	10
9 51475	Cutting Tip 70A	10
9 51476	Cutting Tip 80A	10
9 51477	Cutting Tip 90/100A	10
9 51478	Cutting Tip 120A	10
10 60442	Coil Spring	5
11 60480	Std Shield Cup 30/60A c/w item 10	1
11 60481	Std Shield Cup 60/120A c/w item 10	1

### Main Consumables (continued)

Code	Description	Pack Qty
12 51480	Contact Cutting Tip 30A	10
51481	Contact Cutting Tip 40A	10
51482	Contact Cutting Tip 50/60A	10
51484	Contact Cutting Tip 60A	10
51485	Contact Cutting Tip 70A	10
51486	Contact Cutting Tip 80A	10
51487	Contact Cutting Tip 90/100A	10
51488	Contact Cutting Tip 120A	10
13 51490	Extended Contact Cutting Tip 30A	10
51491	Extended Contact Cutting Tip 40A	10
51492	Extended Contact Cutting Tip 50/60A	10
51493	Extended Contact Cutting Tip 60A	10
51494	Extended Contact Cutting Tip 70A	10
51495	Extended Contact Cutting Tip 80A	10
51496	Extended Contact Cutting Tip 90/100A	10
51497	Extended Contact Cutting Tip 120A	10
14 60482	Contact Shield Cup 30/60A c/w item 10	1
60483	Contact Shield Cup 60/120A c/w item 10	1
15 60487	Shield Cap 30/60A	2
16 60488	Shield Cap 60/120A	2
17 60490	Extended Shield Cap 30/60A	2
18 60491	Extended Shield Cap 60/120A	2

### Secondary Consumables

19 07215	Positioning Tube	1
20 07217	Mounting Block	1
21 07216	Positioning Tube with Rack	1
22 7-2827	Pinion Assy	1
23 09090	6m Comp Cable Assy 9/16" Std Connection	1
09095	12m Comp Cable Assy 9/16" Std Connection	1
24 C534-4	Central Connection Kit c/w 4 Pins	1