

## Compatible Cebora

Model: Prof 70

Gas: Single • Air Flow: 180 Litres Per Min • Rating: 70A @ 60% Duty Cycle • EN60974-7 • Cutting Capacity: 20mm Max Most Materials

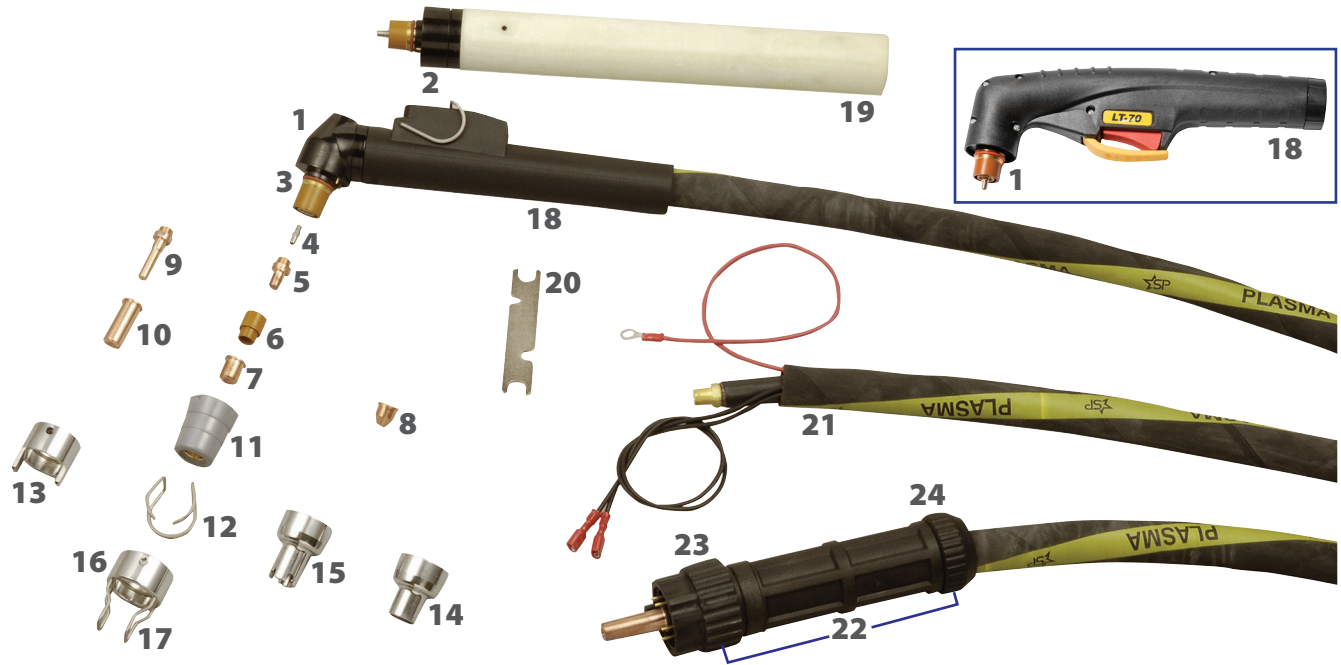

### Torch Packages

| Code       | Description                          |
|------------|--------------------------------------|
| C1564      | Hand Torch 6m 1/8" Bsp Fitting       |
| C1573      | Hand Torch 6m Central Fitting        |
| C1573.20   | Hand Torch 12m Central Fitting       |
| C1563      | Machine Torch 6m 1/8" Bsp Fitting    |
| C1566      | Machine Torch 6m Central Fitting     |
| C1566.20   | Machine Torch 12m Central Fitting    |
| C1564LT    | LT-70 Hand Torch 6m 1/8" Bsp Fitting |
| C1573LT    | LT-70 Hand Torch 6m Central Fitting  |
| C1573.20LT | LT-70 Hand Torch 12m Central Fitting |

### Main Consumables

| Code | Description                      | Pack Qty |
|------|----------------------------------|----------|
| 1    | C1351 Torch Head - Hand          | 1        |
|      | 01071 LT-70 Torch Head           | 1        |
| 2    | C1349 Torch Head - Machine Torch | 1        |
| 3    | C3160067 'O' Ring - Torch Head   | 10       |
| 4    | C3065204 Diffuser                | 1        |
| 5    | C1402 Electrode                  | 5        |
| 6    | C1510 Swirl Ring                 | 1        |
| 7    | C1309 Tip 0.9 - 35A              | 5        |
|      | C1396 Tip 1.0 - 50A              | 5        |
|      | C1308 Tip 1.2 - 70A              | 5        |
| 8    | C1305 Conical Tip 1.0 - Lo Amp   | 5        |
| 9    | C1368 Extended Electrode Hafnium | 5        |
| 10   | C1366 Extended Tip 0.9 - 35A     | 5        |
|      | C1395 Extended Tip 1.0 - 50A     | 5        |
|      | C1395/L Extended Tip 1.2 - 70A   | 5        |
| 11   | C5.710.171 Nozzle Retaining Cap  | 1        |
| 12   | C1397 Spacer Spring              | 5        |

### Main Consumables (continued)

| Code | Description                                   | Pack Qty |
|------|---|----------|
| 13   | C1405 Double Pointed Spacer                   | 1        |
| 14   | 051970 Shield Cup for Extended Tips           | 1        |
| 15   | C1019 Spacer for Contact Cut Ext. Consumables | 1        |
| 16   | 060382 Spacer c/w Stand of Springs            | 1        |
| 17   | 060383 Spacer Springs                         | 5        |

### Secondary Consumables

|    |  |   |
|----|--|---|
| 18 | C1356 Handle c/w Switch - Hand Torch               | 1 |
|    | 09606 LT-70 Handle c/w Switch                      | 1 |
| 19 | C3055623 Handle Machine Torch                      | 1 |
| 20 | C3045012 Wrench for Electrode                      | 1 |
| 21 | C1344 6m Comp Cable Assy 1/8" Bsp Hand Torch       | 1 |
|    | C1344.20 12m Comp. Cable Assy 1/8" Bsp Hand Torch  | 1 |
|    | C1346 6m Comp. Cable Assy 1/8" Bsp Mach. Torch     | 1 |
|    | C1346.20 12m Comp. Cable Assy 1/8" Bsp Mach. Torch | 1 |
| 22 | C534 Central Connector c/w 6 Pins                  | 1 |
| 23 | C539 Plastic Locking Ring                          | 1 |
| 24 | C540 Adaptor Housing                               | 1 |

### Miscellaneous Parts (not illustrated)

|  |   |   |
|--|---|---|
|  | C536 Adaptor 1/8" to 1/4"                   | 1 |
|  | C537 Adaptor Body Only                      | 1 |
|  | C538 Pin for Switch & Safety Cable          | 5 |
|  | C541 Socket for Pilot Cable                 | 5 |
|  | C542 Adaptor Housing Screw                  | 5 |
|  | C543 Switch & Safety Pin Central Connection | 5 |
|  | C544 Pilot Pin Male to Male                 | 5 |