

## MIG Machine Conversion Kits & Central Connector Fittings

Model: CONV

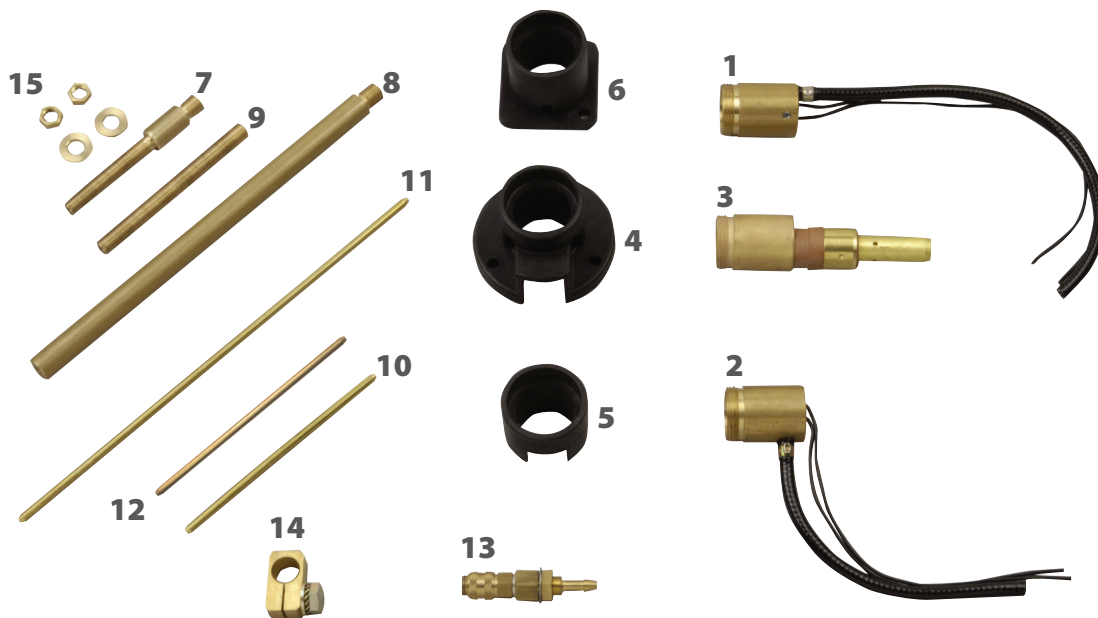

### Complete Conversion Kits

Code	Description	Pack Qty
SP1000	Universal Conversion Kit consists of:	1
<b>1</b>	SP2000	
<b>4</b>	SP2010	
<b>9</b>	SP2043	
<b>10</b>	SP2050	
<b>15</b>	SP2052	
SP1001	Std Long Conversion Kit consists of:	1
<b>1</b>	SP2000	
<b>4</b>	SP2010	
<b>8</b>	SP2041	
<b>11</b>	SP2051	
<b>14</b>	SP2020	
SP1002	Std Short Conversion Kit consists of:	1
<b>1</b>	SP2000	
<b>4</b>	SP2010	
<b>7</b>	SP2040	
<b>10</b>	SP2050	
<b>14</b>	SP2020	
SP1003	Esab A10 Conversion Kit consists of:	1
<b>3</b>	SP2003	
<b>4</b>	SP2010	
<b>10</b>	SP2050	

### Machine (Euro Body)

Code	Description	Pack Qty
<b>1</b>	SP2000 Standard Connection Block	1
<b>2</b>	SP2001 Side Entry Connection Block	1
<b>3</b>	SP2003 Esab A10 Connection Book	1

### Machine (Plastic Flanges)

<b>4</b>	SP2010 Plastic Flange 85mm Dia.	1
<b>5</b>	SP2011 Plastic Flange 50mm Dia.	1
<b>6</b>	SP2012 Square Plastic Flange	1

### Brass Guides

<b>7</b>	SP2040 Standard Short Brass Guide M12x1 x M10x1 x 16mm Dia.	1
<b>8</b>	SP2041 Standard Long Brass Guide. M12x1 x16mm Dia.	1
<b>9</b>	SP2043 Threaded Brass Guide M12x1mm Threaded Bar	1

### Capillary Tubes

<b>10</b>	SP2050 150mm x 5mm OD x 2mm ID Tube	1
<b>11</b>	SP2051 300mm x 5mm OD x 2mm ID Tube	1
<b>12</b>	SP2055 100mm x 5mm OD x 2mm ID Tube	1

### Miscellaneous Parts

<b>13</b>	SP3529 Quick Disconnect Panel Mounted Connector	1
<b>14</b>	SP2020 Current Clamp	1
<b>15</b>	SP2052 Washer & Nut Pack	1